

## Creating Forms

### Forms:

Forms in MDO are how we want to display the fields on our transaction screens.

### To create forms in MDO Fuse, follow these steps:

- Click on "Forms and rules"

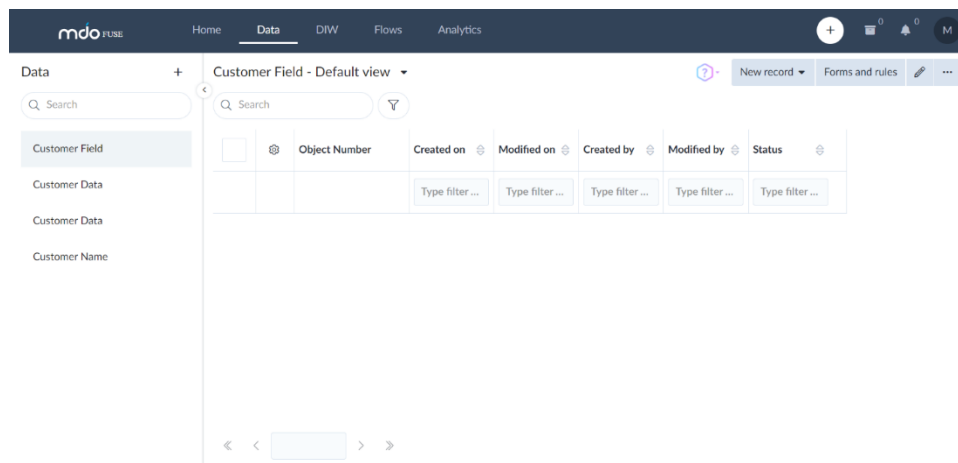

- Click on "New form" and then click on Flow

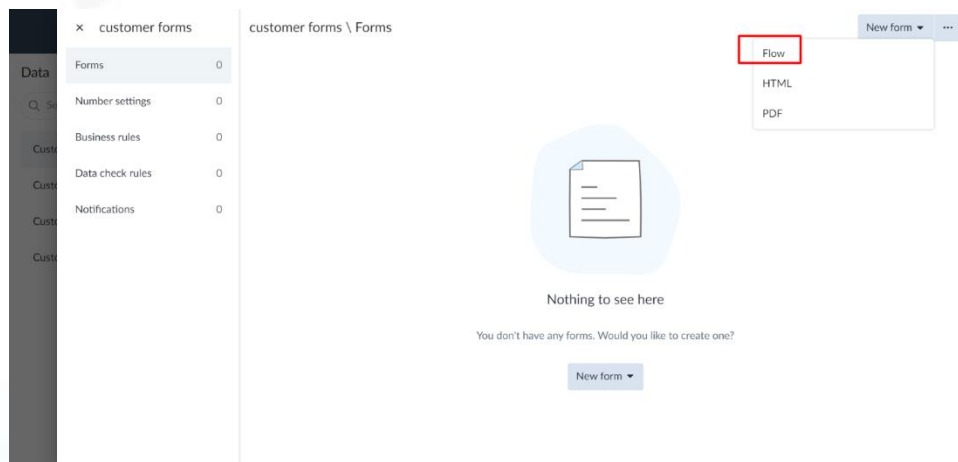

- Give the form a name, form usage, you can enable the form for description generator and add a dependency rule to your form.

### Description generator:

When the user enables the description generator, MDO generates descriptions based on the field attributes.

### Dependency rule

A Dependency Rule enables a user to create rules for a field or set of fields that are dependent on the values of other fields. This can include populating the value of a target field(s) based on the value of a source field(s).

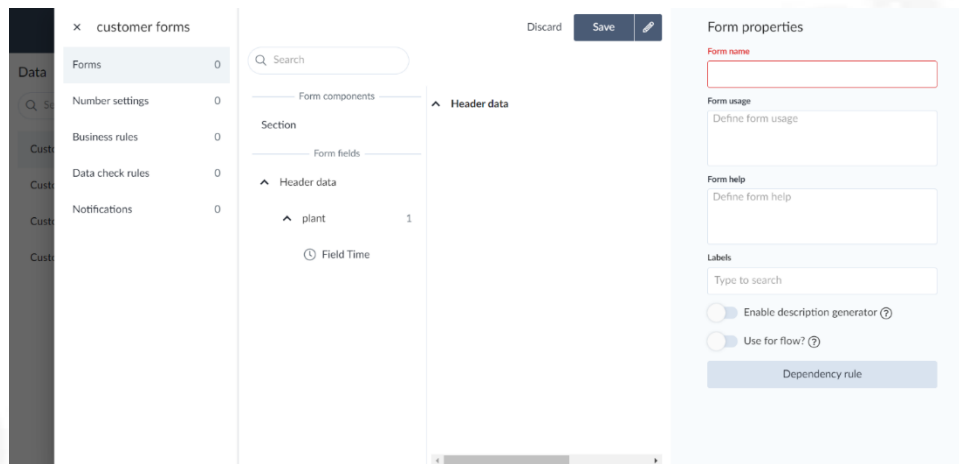

- Once done, click on “save” to save the form

### Adding fields to the header data:

- **Form components** –

Section- to add blocks to the form

- **Form fields**- to add fields to the section

To add section or fields to the form, simply drag and drop the dataset from the left-hand side.

Once the fields are added, the user will be able to see the icons below:



- to hide fields in the form



- to make the field editable in the form



- to make the field mandatory

## Adding dependency rules to a form:

To add dependency rule to a form, click on the “dependency rule” option:

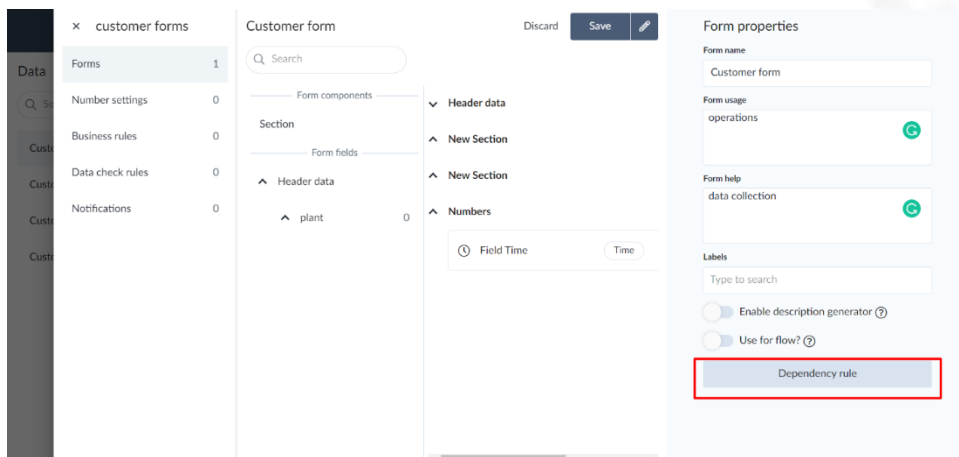

- Enter the source and target field and click on “save”.

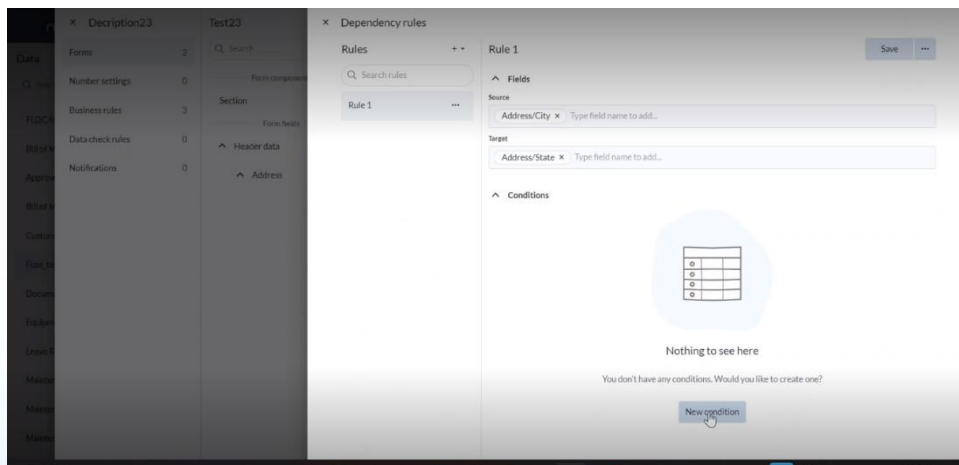

- Click on "New Condition" to add conditions

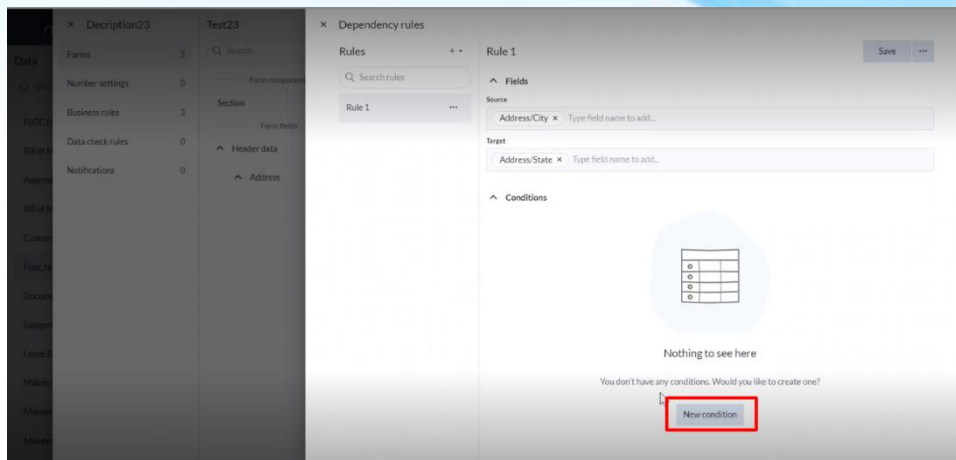

- Enter the source and target fields. Similarly, users can add more conditions.

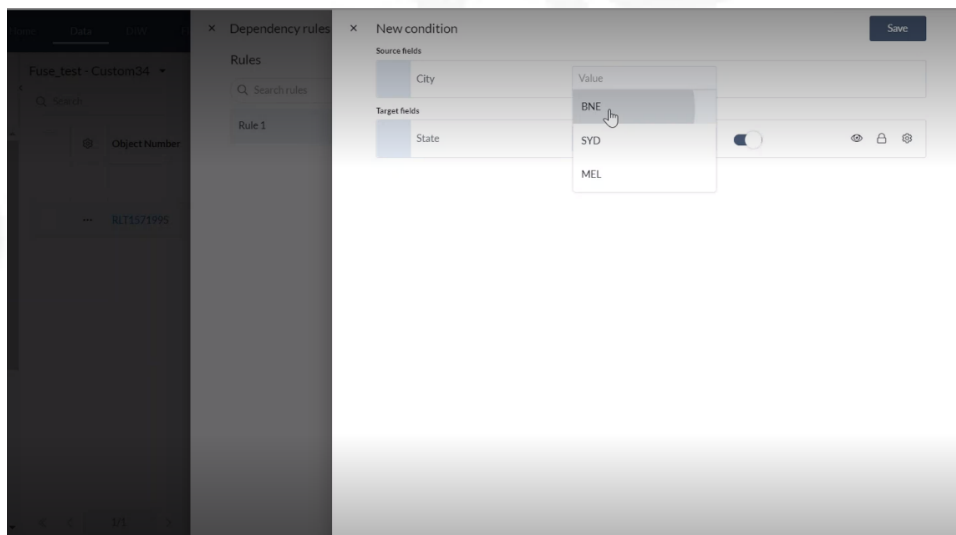

- Once done, click on "save." Users can edit or duplicate the form once created.